

Need help from Arlo?

We are here for you.

Visit www.arlo.com/support for quick answers and resources:

- How-to videos
- Troubleshooting tips
- Additional support resources

Mobile service

For help with your Go 2 mobile service plan, contact the carrier who provided the SIM card. If no SIM card was included, visit your local carrier to activate a service plan and receive a SIM card.



Go 2 LTE/WiFi Security Camera



Go 2 LTE/WiFi
Security Camera



Screw
Mount



Screw
Kit



Rechargeable
Battery

Note: To access the mobile broadband network, your Go 2 Camera requires an activated SIM card.



Indoor charging cable



201-50642-01

Installation

1. Press the release button and separate the camera from the camera housing.

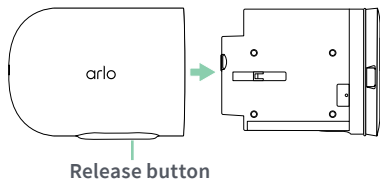

2. Insert the battery.

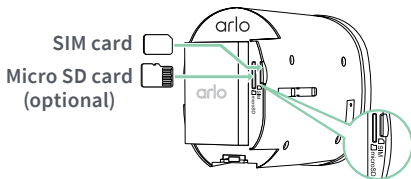

3. For LTE access, verify that the SIM card is installed and activated.
4. Insert the camera back into the housing.

Set up your Go 2 Camera

1. Download the Arlo app and follow the setup instructions for your camera.



2. We recommend charging the battery indoors before mounting your camera.

© Arlo Technologies, Inc. Arlo, Arlo logo, and Every Angle Covered are trademarks of Arlo Technologies, Inc. App Store is a service mark of Apple Inc. Google Play and the Google Play logo are trademarks of Google LLC. Any other trademarks are for reference purposes.

Si ce produit est vendu au Canada, vous pouvez accéder à ce document en français canadien à arlo.com/docs.

(If this product is sold in Canada, you can access this document in Canadian French at arlo.com/docs.)

For regulatory compliance information including the EU Declaration of Conformity, visit www.arlo.com/about/regulatory/.

Arlo Technologies, Inc.
2200 Faraday Avenue, Suite 150
Carlsbad, CA 92008 USA

Arlo Technologies Intl. Ltd
Ground Floor, Building 3
University Technology Centre
Curraheen Road, Cork T12 EF21 Ireland

